

MONOPOINT INTERNATIONAL CM1 HANG STRAIGHT

An innovative solution for sloped ceilings, this monopoint “hang straight” can suspend with a rigid stem up to 4’ in length, for ceiling pitches up to 45° while still allowing for a full 90° tilt.



ORDERING INFORMATION - MONOPOINT

CYLINDER	LENGTH	FIXTURE	BODY FINISH	BAFFLE FINISH	STEM FINISH	CRI / WATTAGE PACKAGE	CCT	OPTIC (UGR)	DRIVER	MEDIA	MOUNTING
CM1		HS1									E
CM1 66mm	LENGTHS SL 3" Standard 24 24" 48 48" 24" AND 48" STEMS ARE FIELD CUTTABLE. 3" STANDARD LENGTH STEM IS MINIMUM LENGTH.	ADJUSTABLE DRY / DAMP HS1 Adjustable 90° Fixture Tilt, Max ceiling pitch 12/12 (45°)	POWDERCOAT	POWDERCOAT	POWDERCOAT	STATIC WHITE	24 2400K* *(90+ CRI only)	10 10° (>19)	INTEGRAL IE Electronic ELV / TRIAC 220V-240V REMOTE IG eldoLED, SOLOdrive 0.1% 0-10V, LOG 120V-277V IN eldoLED, SOLOdrive 0.1% 0-10V, LIN 120V-277V ID eldoLED, SOLOdrive 0.1% DALI-2, LOG 120V-277V REMOTE TUNABLE WHITE DD eldoLED, DUALdrive 0.1% DALI-2, LOG 120V-277V	STANDARD MEDIA 4 Soft Focus Lens* *(Required for 10° optic) ALTERNATE MEDIA 2 Honeycomb Louver* *(Not available for IP65 Wet Location) 3 Clear Glass Lens 5 Frosted Glass Lens 6 Frosted Soft Focus Lens 7 Frosted Linear Spread Lens S Soft Focus Lens w/ Honeycomb Louver F Frosted Glass Lens w/ Honeycomb Louver N No Lens* *(Not available for IP65 Wet Location)	E EXMP Export Mounting Plate. Features 83mm diameter canopy
			WH White	WH White	WH White	80S11A 80+ CRI, 11 Watts Lumens Delivered - 1095	27 2700K	15 15° (<13)			
			BK Black	BK Black	BK Black	90S11A 90+ CRI, 11 Watts Lumens Delivered - 941	30 3000K	20 20° (<10)			
			AB Architectural Bronze	AB Architectural Bronze	AB Architectural Bronze	97S11A 97+ CRI, 11 Watts Lumens Delivered - 826	35 3500K	25 25° (<10)			
			AG Satin Silver	AG Satin Silver	AG Satin Silver		40 4000K	40 40° (<10)			
			AU Cashmere Gold	AU Cashmere Gold	AU Cashmere Gold			60 60° (<13)			
			BB Burnt Bronze	BB Burnt Bronze	BB Burnt Bronze						
			CF Custom Finish* *(Consult Factory)	CF Custom Finish* *(Consult Factory)	CF Custom Finish* *(Consult Factory)						
			ALUMINA	ALUMINA	ALUMINA						
			01 Brushed Obsidian	01 Brushed Obsidian	01 Brushed Obsidian						
02 Matte Obsidian	02 Matte Obsidian	02 Matte Obsidian									
03 Brushed Dark Patinated Bronze	03 Brushed Dark Patinated Bronze	03 Brushed Dark Patinated Bronze									
04 Matte Dark Patinated Bronze	04 Matte Dark Patinated Bronze	04 Matte Dark Patinated Bronze									
05 Brushed Aged Aluminum	05 Brushed Aged Aluminum	05 Brushed Aged Aluminum									
06 Matte Aged Aluminum	06 Matte Aged Aluminum	06 Matte Aged Aluminum									
07 Brushed Cast Brass	07 Brushed Cast Brass	07 Brushed Cast Brass									
08 Matte Cast Brass	08 Matte Cast Brass	08 Matte Cast Brass									
09 Brushed Light Patinated Bronze	09 Brushed Light Patinated Bronze	09 Brushed Light Patinated Bronze									
10 Matte Light Patinated Bronze	10 Matte Light Patinated Bronze	10 Matte Light Patinated Bronze									
			ALUMINA NOT RECOMMENDED FOR EXTERIOR APPLICATIONS, FINISHES ARE NOT UV RATED								
						ALL LUMENS DELIVERED REFLECT 3000K PAIRED WITH 25° OPTIC AND SOFT FOCUS LENS					

PART NUMBER NOTES

CM1 ships as e.g., CM124HS1WHBK90S11*3040LVS4F

Remote driver ships as e.g., PS-RMT-90S-17A-IG*

PART NUMBER NOTES



- CM1 ships as e.g., CM124HS1WHBK90S11*3040LVS4F
- Remote driver ships as e.g., PS-RMT-90S-17A-IG*



MONOPOINT INTERNATIONAL CM1 HANG STRAIGHT

FINISHES

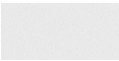
POWDERCOAT FINISHES

					
(WH) White	(BK) Black	(AB) Architectural Bronze	(AG) Satin Silver	(AU) Cashmere Gold	(BB) Burnt Bronze

ALUMINA FINISHES BY LUCIFER LIGHTING™

				
(01) Brushed Obsidian	(03) Brushed Dark Patinated Bronze	(05) Brushed Aged Aluminum	(07) Brushed Cast Brass	(09) Brushed Light Patinated Bronze
				
(02) Matte Obsidian	(04) Matte Dark Patinated Bronze	(06) Matte Aged Aluminum	(08) Matte Cast Brass	(10) Matte Light Patinated Bronze

ACCESSORIES

REPLACEMENT MEDIA

- ☐ **HCL-CT1** Honeycomb Louver*
- ☐ **CGL-CT1** Clear Glass Lens
- ☐ **SFL-CT1** Soft Focus Lens
- ☐ **FGL-CT1** Frosted Glass Lens
- ☐ **FSFL-CT1** Frosted Soft Focus Lens
- ☐ **FLSL-CT1** Frosted Linear Spread Lens

REPLACEMENT OPTICS

Interchangeable optics accessible by removing baffle.

Static White		Warm Dim		Tunable White	
<input type="checkbox"/> RO-50-15-S	15° optic	<input type="checkbox"/> RO-50-15-W	15° optic	<input type="checkbox"/> RO-50-15-S	15° optic
<input type="checkbox"/> RO-50-20-S	20° optic	<input type="checkbox"/> RO-50-20-W	20° optic	<input type="checkbox"/> RO-50-20-S	20° optic
<input type="checkbox"/> RO-50-25-S	25° optic	<input type="checkbox"/> RO-50-25-W	25° optic	<input type="checkbox"/> RO-50-25-S	25° optic
<input type="checkbox"/> RO-50-40-S	40° optic	<input type="checkbox"/> RO-50-40-W	40° optic	<input type="checkbox"/> RO-50-40-S	40° optic
<input type="checkbox"/> RO-50-60-S	60° optic	<input type="checkbox"/> RO-50-60-W	60° optic	<input type="checkbox"/> RO-50-60-S	60° optic

MONOPOINT INTERNATIONAL CM1 HANG STRAIGHT

PERFORMANCE - 3000K

LUMEN PACKAGE	WATTAGE	10° OPTIC FIELD REDUCER		15° OPTIC SOFT FOCUS LENS		20° OPTIC SOFT FOCUS LENS		25° OPTIC SOFT FOCUS LENS		40° OPTIC SOFT FOCUS LENS		60° OPTIC SOFT FOCUS LENS	
		DELIVERED	LPW	DELIVERED	LPW	DELIVERED	LPW	DELIVERED	LPW	DELIVERED	LPW	DELIVERED	LPW
80S11A	11	454	41	991	90	1093	99	1095	100	1019	93	1145	104
80S17A	17	619	36	1435	84	1701	100	1655	97	1513	89	1640	96
90S11A	11	391	35	851	86	939	95	941	96	875	89	984	100
90S17A	17	532	31	1233	76	1461	90	1422	87	1300	80	1409	86
97S11A	11	337	30	747	68	824	75	826	75	768	70	864	79
97S17A	17	460	27	1083	64	1283	75	1249	73	1141	67	1237	73
90L11A (2700K-1800K)	11	-	-	830	75	945	86	920	84	851	77	918	83
90L11A (3000K-1800K)	11	-	-	872	79	993	90	967	88	895	81	964	88
90L17A (2700K-1800K)	17	-	-	1107	65	1261	74	1227	72	1135	67	1223	72
90L17A (3000K-1800K)	17	-	-	1164	68	1326	78	1291	76	1194	70	1287	76
90T17A (4000K-1800K)	17	-	-	798	47	917	54	896	53	811	48	910	54
90T17A (5000K-2700K)	17	-	-	791	47	909	53	888	52	803	47	902	53

Part L

75+ LPW configurations comply with residential Part L
95+ LPW configurations comply with commercial Part L

UNIFIED GLARE RATING

10° OPTIC FIELD REDUCER	15° OPTIC SOFT FOCUS LENS	20° OPTIC SOFT FOCUS LENS	25° OPTIC SOFT FOCUS LENS	40° OPTIC SOFT FOCUS LENS	60° OPTIC SOFT FOCUS LENS
>19	<16	<10	<10	<10	<16

MEDIA LIGHT LOSS MULTIPLIER

MEDIA	LIGHT LOSS FACTOR
No Lens	1.05
CGL	0.97
SFL	1.00
FGL	0.85
FSFL	0.82
FLSL	0.78
HCL	0.75
SFL W/ HCL	0.68
FGL W/ HCL	0.47

OUTPUT MULTIPLIER

CCT	CCT SCALE
2400K	0.85
2700K	0.97
3000K	1.000
3500K	1.03
4000K	1.08

TUNABLE WHITE MULTIPLIER

CCT	5000K-2700K	4000K-1800K
5000K	1.16	-
4000K	1.08	1.14
3500K	1.04	1.07
3000K	1.00	1.00
2700K	0.96	0.92
2400K	-	0.84
1800K	-	0.69

MONOPOINT INTERNATIONAL CM1 HANG STRAIGHT

WARM DIM PERFORMANCE - SOFT FOCUS LENS - 25° OPTIC

INCANDESCENT PROFILE							
90L11AWL 2700K - 1800K	Full on 100%	Dimmed to 80%	Dimmed to 70%	Dimmed to 50%	Dimmed to 20%	Dimmed to 10%	Dimmed to 2%
CCT (K)	2700	2700	2700	2600	2200	1900	1800
Light Output (Lm)	920	736	644	460	184	92	18
Power (W)	11	8.8	7.7	5.5	2.2	1.1	0.2
Efficacy (LPW)	84	84	84	84	84	84	84
90L17AWL 2700K - 1800K	Full on 100%	Dimmed to 80%	Dimmed to 70%	Dimmed to 50%	Dimmed to 20%	Dimmed to 10%	Dimmed to 2%
CCT (K)	2700K	2700K	2700K	2700K	2500K	1950K	1800K
Light Output (Lm)	1227	982	859	614	245	123	25
Power (W)	22	17.6	15.4	11	4.4	2.2	0.4
Efficacy (LPW)	72	72	72	72	72	72	72

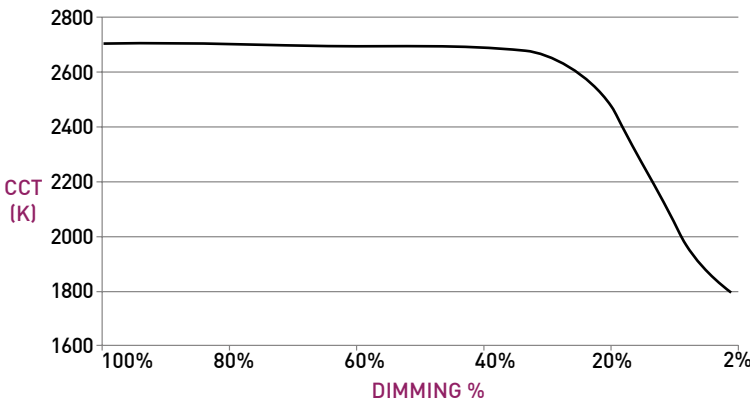

NOTE: LIN-TO-LIN 0-10V PAIRING NOT COMPATIBLE WITH WARM DIM.

HALOGEN PROFILE							
90L11AWD 3000K - 1800K	Full on 100%	Dimmed to 80%	Dimmed to 70%	Dimmed to 50%	Dimmed to 20%	Dimmed to 10%	Dimmed to 2%
CCT (K)	3000	3000	3000	3000	2500	1900	1800
Light Output (Lm)	967	774	677	484	193	97	19
Power (W)	11	8.8	7.7	5.5	2.2	1.1	0.2
Efficacy (LPW)	88	88	88	88	88	88	88
90L17AWD 3000K - 1800K	Full on 100%	Dimmed to 80%	Dimmed to 70%	Dimmed to 50%	Dimmed to 20%	Dimmed to 10%	Dimmed to 2%
CCT (K)	3000K	3000K	3000K	3000K	3000K	2150K	1800K
Light Output (Lm)	1291	1033	904	646	258	129	26
Power (W)	22	17.6	15.4	11	4.4	2.2	0.4
Efficacy (LPW)	76	76	76	76	76	76	76

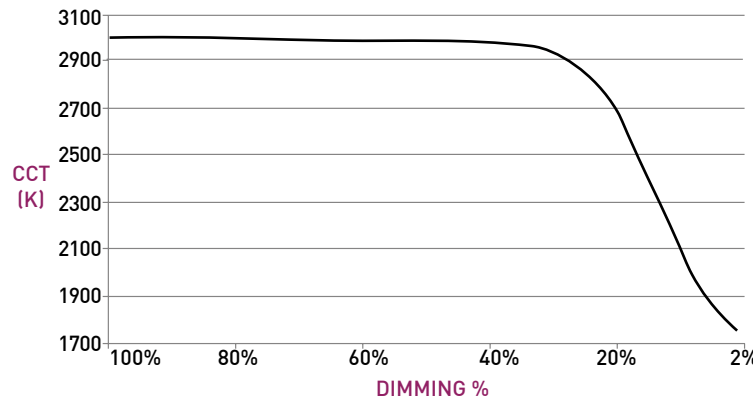

MONOPOINT INTERNATIONAL CM1 HANG STRAIGHT

MONOPOINT

- A EXPORT MOUNTING PLATE**
Export mounting plate (concealed) to be installed above ceiling substrate. Features minimalist 66mm diameter canopy
- B STEM**
Standard length is 3", also available in 24" and 48" lengths. All lengths excepts 3" are field cuttable. Powdercoat finishes standard, consult factory for Alumina finishes.
- C BODY**
Available in powdercoat and Alumina finishes. Power supply integrated into fixture body.
- D OPTICS**
Robust light engine with optimized optic pairing integrates Reflection, Refraction, and TIR offering 10°, 15°, 20°, 25°, 40° & 60° beams.
- E 10° FIELD REDUCER**
Soft Focus Lens, Honeycomb Louver, and Field Reducer provided with 10° optic. Reduces field angle by 30%.
- F MEDIA**
Soft Focus Lens standard. Wet location media sealed in place.
- G BAFFLE**
Accepts 2 media devices. Baffle minimizes aperture glare and conceals view into fixture. Powdercoat finishes standard, consult factory for Alumina finishes.
- H HANG STRAIGHT CANOPY**
Features hidden ball joint that accommodates installations on up to 12/12 (45°) sloped ceilings.
- I ADJUSTABILITY**
Features locking 90° tilt and 365° rotation. Stem features 45° tilt to accommodate up to 12/12 slopes.

REMOTE POWER SUPPLY

- J Remote power supply provides additional driver options.** See page 5 for maximum allowable wiring distance. Must be installed in an accessible location.

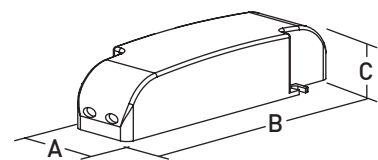
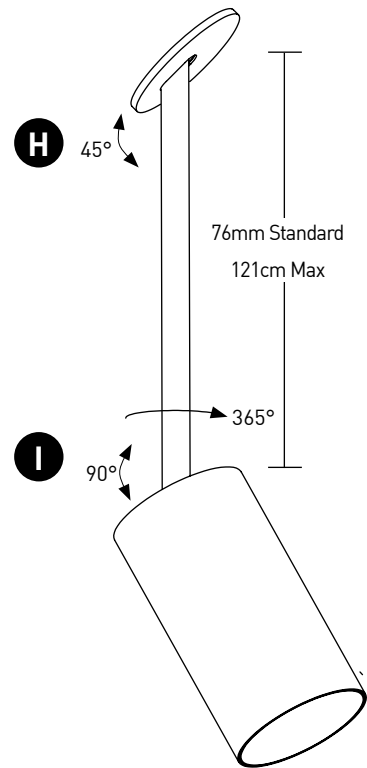
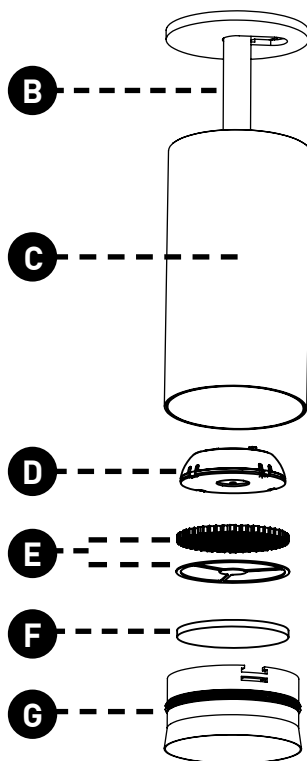
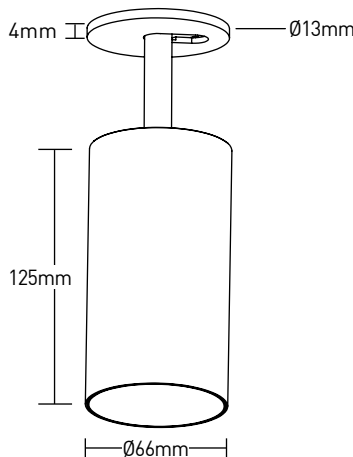
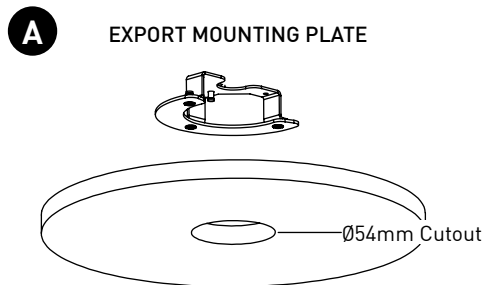

POWER SUPPLY DIMENSIONS			
Model	A	B	C
IG	41mm	210mm	34mm
IN			
ID			
DD	76mm	130mm	30mm

MONOPOINT INTERNATIONAL CM1 HANG STRAIGHT

TECHNICAL

CONSTRUCTION

Monopoint: Machined aluminum body; painted finishes are granulated powder coat; Alumina finishes are anodized aluminum.

STATIC WHITE LED

2-step MacAdam ellipse LED module available in 80+, 90+ and 97+ CRI configurations in color temperatures of 2700K, 3000K, 3500K and 4000K.
3-step MacAdam ellipse LED module available in 90+ CRI configurations in color temperature of 2400K. Average rated lamp life of 50,000 hours.

WARM DIM LED

3-step MacAdam ellipse warm dim LED module available in 90+ CRI configuration. 3000K or 2700K at full brightness, warming to 1800K at full dim. Average rated lamp life of 50,000 hours.

TUNABLE WHITE LED

3-step MacAdam ellipse tunable white LED module available in 90+ CRI configuration. Features tuning ranges of 1800K to 4000K and 2700K to 5000K. Average rated lamp life of 50,000 hours.

POWER SUPPLY PERFORMANCE AND DIMMING INFORMATION

	PHASE		0-10V		DALI	
Power Supply	IE	IG	IN	ID	DD	
Minimum °C	-20 °C	-20 °C	-20 °C	-20 °C	-20 °C	
Maximum °C	40 °C	40 °C	40 °C	40 °C	40 °C	
Dimming %	2.0%	0.1%	0.1%	0.1%	0.1%	

Note: For IG and IN drivers consult chart on page 7 to confirm appropriate dimming curve for compatibility with selected control.

MAXIMUM ALLOWABLE REMOTE DRIVER WIRING DISTANCES

	WIRE AWG				
DRIVER	12	14	16	18	20
IG, IN, ID, DD	-	-	118'	72'	46'

LISTING

Monopoints and drivers CE Listed for Dry / Damp locations.
Integral drivers ENEC and CB Listed. NOM Certified.

DECLARE

LBC Red List Approved.

PART L

Part L compliant for all 75+ LPW residential and 95+ LPW commercial configurations.

LIMITED WARRANTY

Manufacturer's Limited Warranty guarantees product(s) listed to be free from defects in material and workmanship under normal use and service for 1-year. LED and power supplies are warranted to operate with 70% of original flux and remain within a range of 3 duv for a period of 5-years. Warranty period begins from the date of shipment by Seller. [Consult website for full warranty terms and conditions.](#)

CHANGE LOG

- 1.02/13/2024: ADDED TUNABLE WHITE OFFERING.
- 2.2/15/2024: PART L COMPLIANCE ADDED.
- 3.03/18/2024: UPDATED 10 DEGREE NARROW BEAM TO UTILIZE FILED REDUCER.
- 4.09/19/2024: UPDATED WITH NEW BAFFLE DESIGN.
- 5.05/07/2025: UPDATED WARM DIM OFFERING.



MONOPOINT INTERNATIONAL CM1 HANG STRAIGHT

DIMMING COMPATABILITY

eldoLED DRIVER COMPATIBILITY

Power supply IG Manufacturer	Family/Model #
Busch-Jaeger	2112U-101
Jung	240-10
Leviton Lighting Controls	IP710-DLX
Lightolier Controls	ZP600FAM120
Merten	5729
Pass & Seymour	CD4FB-W
The Watt Stopper	DCLV1
Synergy	ISD BC
Crestron®	GLX-DIMFLV8
Crestron®	GLXP-DIMFLV8
Crestron®	GLPAC-DIMFLV4-*
Crestron®	GLPAC-DIMFLV8-*
Crestron®	GLPP-DIMFLVEX-PM
Crestron®	GLPP-1DIMFLV2EX-PM
Crestron®	GLPP-1DIMFLV3EX-PM
Crestron®	DIN-A08
Crestron®	DIN-4DIMFLV4
Crestron®	CLS-EXP-DIMFLV
Crestron®	CLCI-1DIMFLV2EX
Power supply IN Manufacturer	Family/Model #
Lutron Electronics	Nova T® - NTFTV
Lutron Electronics	Diva® - DDTV
Lutron Electronics	Nova® - NFTV
Lutron Electronics	GrafixEye® GRX-TVI w GRX3503
Lutron Electronics	Energy Savr Node™ - QSN-4T16-S
Lutron Electronics	TVM2 Module
Sensor Switch	nIO EZ
ABB	SD/S 2.16.1